

WET WELL REMOVAL DETAIL
NOT TO SCALE

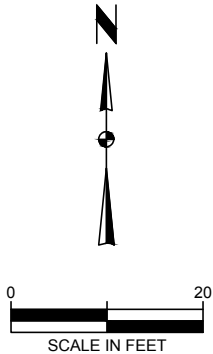

UTILITY QUALITY SERVICE LEVELS
QUALITY LEVELS OF UTILITIES SHOWN ON THESE PLANS ARE LEVEL "D" (INFORMATION IS DERIVED FROM EXISTING UTILITY RECORDS OR ORAL RECOLLECTION). THE QUALITY LEVELS ARE BASED ON THE CI / ASCE 38-02 STANDARD.

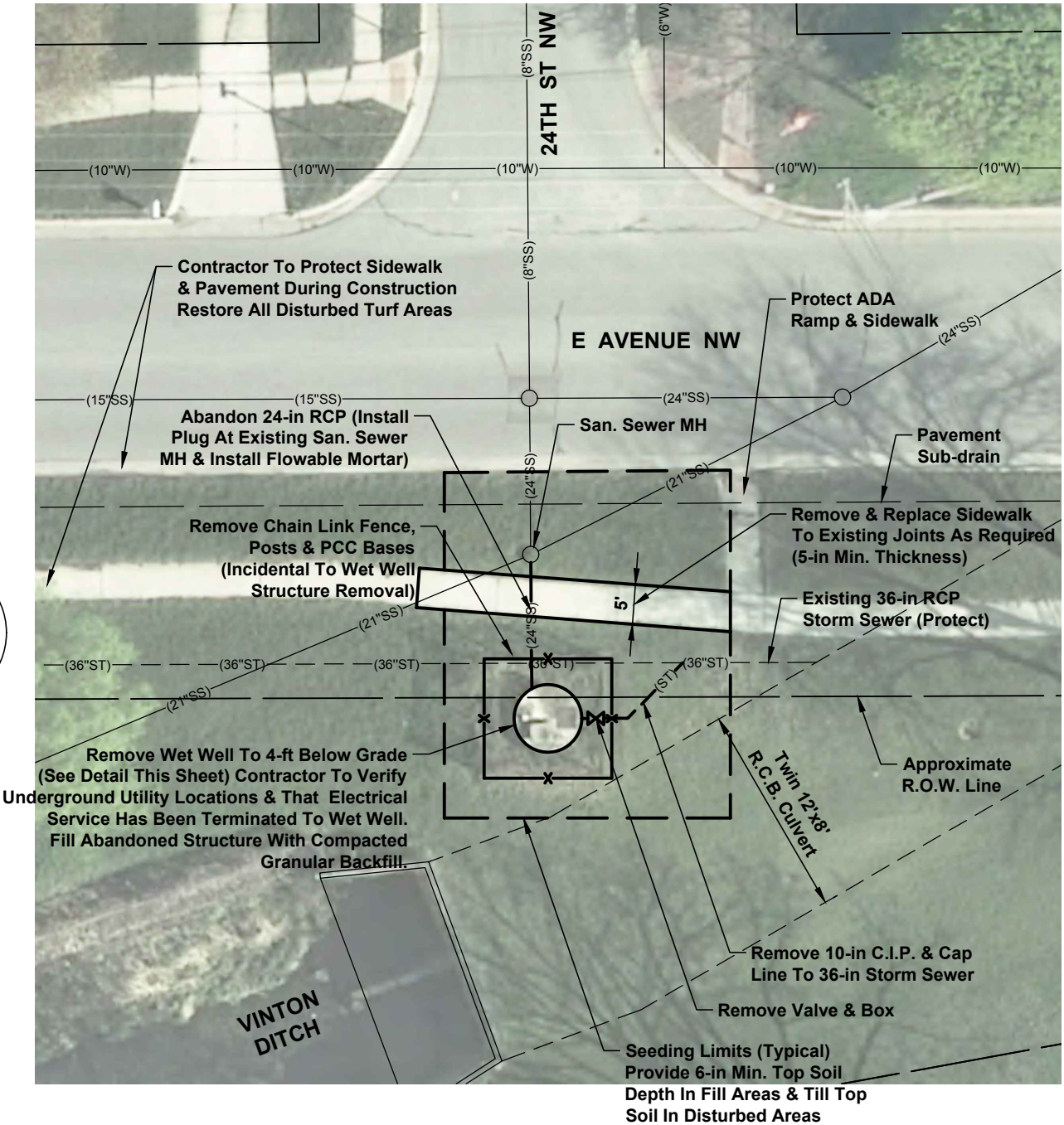

- GENERAL NOTES (ENTIRE PROJECT):**
1. THIS PROJECT SHALL BE CONSTRUCTED IN ACCORDANCE WITH THE CEDAR RAPIDS METROPOLITAN AREA STANDARD SPECIFICATIONS AND DETAILS FOR PUBLIC IMPROVEMENTS, LATEST EDITIONS.
 2. IT SHALL BE THE RESPONSIBILITY OF THE CONTRACTOR TO PROTECT ALL EXISTING UTILITIES AND PAVED AREAS, INCLUDING ANY NOT SHOWN ON THESE DRAWINGS. THE CONTRACTOR SHALL VERIFY ALL EXISTING UTILITIES PRIOR TO CONSTRUCTION AND NOTIFY THE ENGINEER IF ANY CONFLICTS WITH THE DRAWINGS OCCUR. ANY DAMAGE TO EXISTING UTILITIES, SOD, LANDSCAPE AND/OR PAVED AREAS CAUSED BY TRENCHING, GRADING, AND PAVING OPERATIONS NOT IDENTIFIED FOR REPLACEMENT SHALL BE REPAIRED AT THE CONTRACTOR'S EXPENSE. EXISTING UTILITY LOCATIONS SHOWN ON THE DRAWINGS ARE APPROXIMATE.
 3. PROVIDE POSITIVE DRAINAGE AT ALL TIMES WITHIN THE CONSTRUCTION AREAS. DO NOT ALLOW WATER TO DRAIN OR TO POND ONTO ADJOINING PROPERTY OR PUBLIC RIGHT-OF-WAY.
 4. ALL DEBRIS RESULTING FROM CONSTRUCTION OPERATIONS SHALL BE PROPERLY DISPOSED OF OFF-SITE.
 5. RESTORE LANDSCAPED AND LAWN AREAS DISTURBED DURING CONSTRUCTION TO THEIR ORIGINAL CONDITION UPON COMPLETION OF CONSTRUCTION.
 6. REMOVAL OF PCC SIDEWALK SHALL BE INCIDENTAL TO BID ITEM 02700-70 (PORTLAND CEMENT CONCRETE SIDEWALK).

SUMMARY OF QUANTITIES				
No.	Bid Item	Description	Quantity	Unit
1	01100-01	Mobilization	1	LS
2	01200-01	Traffic Control	1	LS
3	01400-42	Removal of Sanitary Sewer Structures	1	EA
4	01400-43	Removal of Sanitary Sewer Pipe, 10-in CIP	20	LF *
5	01400-51	Abandonment of Storm and Sanitary Sewer Pipes with Flowable Mortar	2.3	CY *
6	02000-30	Borrow	16	CY **
7	02700-70	Portland Cement Concrete Sidewalk, 5-in	23	SY *
8	02900-10	Seeding, Fertilizing, and Mulching	162	SY *
9	02905-01	Imported Topsoil	10	TON ***
10	02905-03	Watering	20	EA

Includes 5% Contingency (Added To Plan Quantity) = *
Includes 30% Shrinkage Factor (Added To Plan Quantity) = **
Includes 45% Shrinkage Factor (Added To Plan Quantity) = ***

Plot Date: 12/15/2015 1:54 PM
File Name: w:\projects\cp\011 (655)6550036 e ave nw pump station removal\design\6550036 e ave nw wet well removal.dwg